

47 mm Filtration Sets



LF 30
Video



MF 31
Video



LF 30



MF 31

Features

- LF 30 spin-lock connection facilitates fast and stable installation without clamp.
- MF 31 strong magnetic seal allows one-handed operation
- Excellent smash, high temperature resistance and autoclavable.
- Funnel graduated in 50ml, receiver in 100ml increments for easy measurement.

Specifications

| Material | LF 30 | MF 31 |
|---------------------|-------|---------------------------|
| Filter funnel | PES | PES |
| Funnel support base | PC | PES |
| Membrane support | PP | PES |
| Syringe filter | PTFE | PTFE |
| Receiver flask | PC | Borosilicate glass |
| Drain hose | — | Rubber (non-autoclavable) |

Specifications

| | | |
|---------------------------|----------------------|----------------------|
| Funnel capacity | 300 ml | 300 ml |
| Flask capacity | 1200 ml | 1000 ml |
| Filter diameter | 47 mm / 50 mm | 47 mm / 50 mm |
| Effective filtration area | 12.5 cm ² | 13.1 cm ² |
| Hose barb | 5/16 inch (8 mm) | 5/16 inch (8 mm) |
| Syringe filter | 25 mm, 0.2 µm | 25 mm, 0.2 µm |
| Drain device | — | Yes |
| Overflow protection | Yes | — |

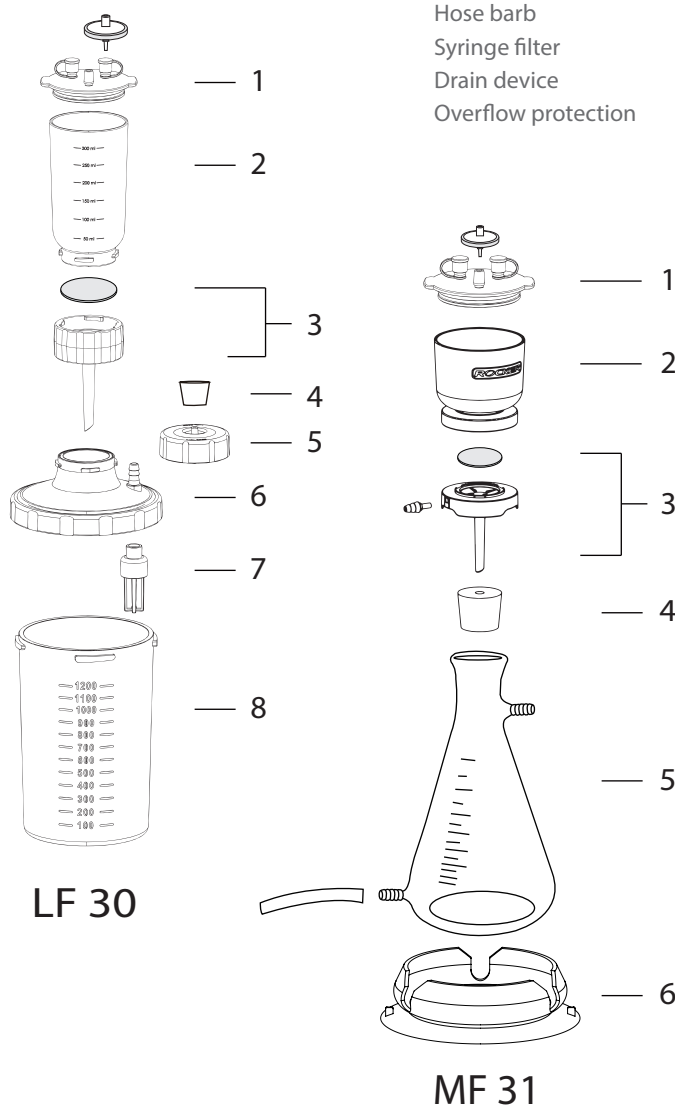

LF 30

MF 31

Ordering Information

LF 30, 47 mm Filtration Set 197010-30

LF 3, PES filter holder (300 ml) 197000-01
(1+2+3+4)

- | | | |
|---|--------------------------|-----------|
| 1 | PP lid kit | 197000-36 |
| 2 | PES funnel, 300 ml | 197000-34 |
| 3 | PC support base | 197000-35 |
| 4 | Silicone stopper (No.16) | 167110-17 |

PC waste bottle with cover, 1200 ml 197000-11-PC
(5+6+7+8)

- | | | |
|---|---------------------|--------------|
| 5 | Black PP cap | 197000-40 |
| 6 | PC cover | 197000-32-PC |
| 7 | Overflow protection | 197000-39 |
| 8 | PC bottle, 1200 ml | 197000-31-PC |

MF 31, 47 mm Filtration Set 200320-31

MF 3, Magnetic filter holder (300ml) 200300-01
(1+2+3+4)

- | | | |
|---|--------------------------------|-----------|
| 1 | PP lid kit for Magnetic funnel | 200300-36 |
| 2 | PES magnetic funnel, 300ml | 200300-30 |
| 3 | PES support base | 200300-32 |
| 4 | Silicone stopper (No.16) | 167110-17 |

- | | | |
|---|------------------------------------|-----------|
| 5 | Receiver flask with drain, 1000 ml | 167300-08 |
| 6 | Silicone fixing sucker | 167200-45 |